

Business Center

Business Center

4-6 stories. Focus is on office space with residential and retail space. Structured parking included.

Chip = 2.5 Acres
38 Households~15 hh/ac
265 Jobs~106 jobs/ac

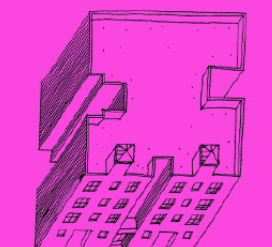

Residential Center

Residential Center

4-6 stories. Focus is on residential space with office and retail space. Structured parking included.

Chip = 2.5 Acres
93 Households~37 hh/ac
98 Jobs~39 jobs/ac



Medium Density Residential

Medium Density Residential

2-4 stories. Residential only.

Chip = 2.5 Acres
45 Households ~18 hh/ac?
0 Jobs ~ 0 jobs/ac



Town Center

Town Center

1-3 stories. Focus is on office and retail. Can be horizontal or vertical mixed use.

Chip = 2.5 Acres
30 Households~12 hh/ac
80 Jobs~32 jobs/ac





Compact Mixed-Use Neighborhood

2-4 stories. Residential focus with some office and retail.

Chip = 2.5 Acres
33 Households~13 hh/ac
18 Jobs~7 jobs/ac



Mixed-Use Neighborhood

1-3 stories. Residential focus with some office and retail.

Chip = 2.5 Acres
23 Households~9 hh/ac
18 Jobs~7 jobs/ac



Craftsman Industrial

1-2 stories. Focus is on revitalizing warehouses into commercial or light industrial units with an emphasis on storefront building type.

Chip = 2.5 Acres
0 Households ~ 0 hh/ac
50 Jobs ~20 jobs/acre



Open Space

Larger parks and undeveloped areas.

Chip = 2.5 Acres
0 Households~0 hh/ac
0 Jobs~0 jobs/ac





Main Street

Main Street

1-2 story traditional main street. Commercial, retail focus with some residential development.

Chip = 1.25 Acres
0 Households~0 hh/ac
46 Jobs~37 jobs/ac



Strip Commercial

Strip Commercial

Common suburban commercial and retail development.

Chip = 1.25 Acres
0 Households~0 hh/ac
23 Jobs~18 jobs/ac



Office Park

Office Park

Focus is on office space. May have compatible light Industrial and tech industry.

Chip = 2.5 Acres
0 Households~0 hh/ac
148 Jobs~59 jobs/ac

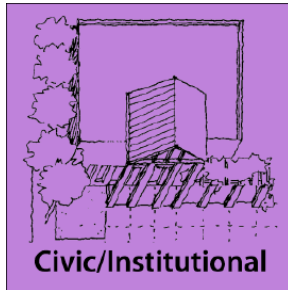

Civic/Institutional

Civic/Institutional

1-5 Stories. Focus is on public services, schools, and campuses.

Chip = 2.5 Acres
0 Households~0 hh/ac
20 Jobs ~ 8 jobs/acre



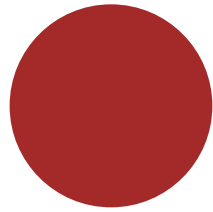

Transit Node

Red stickers can be placed to indicate the addition of transit nodes.

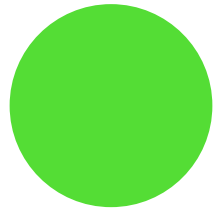

Plazas/Pocket Parks

Green stickers can be placed on the map or on chips to indicate plazas, pocket parks and urban agriculture.

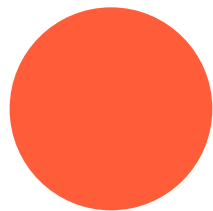

Intersection Improvements

Orange stickers indicate an intersection that is difficult to negotiate or is potentially unsafe.

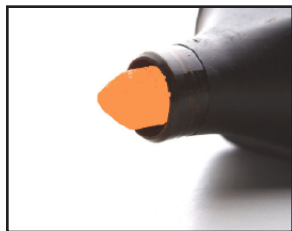

Avenue / Boulevard

Two to four lanes of travel with on street parking and a center median. May contain on street parking, bike lanes and pedestrian amenities.

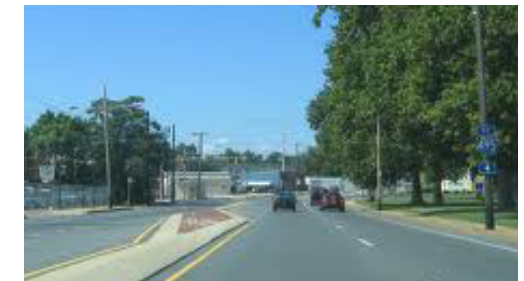
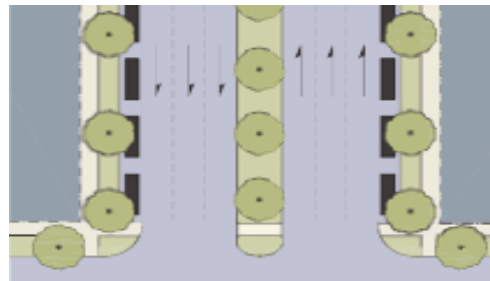

Commercial Street

Two lanes of travel in each direction with on street parking. May contain bike lanes and pedestrian amenities.

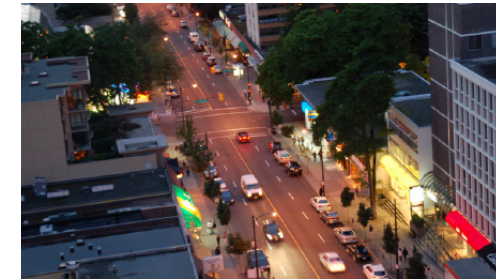

Local Street

Two lanes of travel with on street parking. May contain bike lanes and pedestrian amenities.

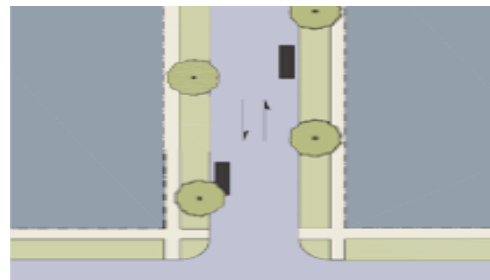

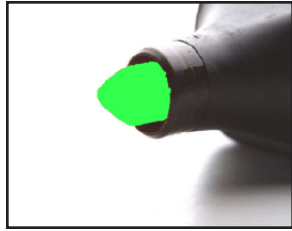

Alley

One lane of low speed travel for local access.

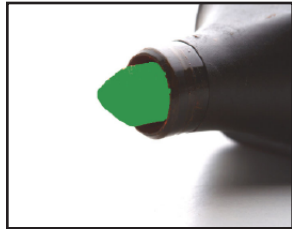
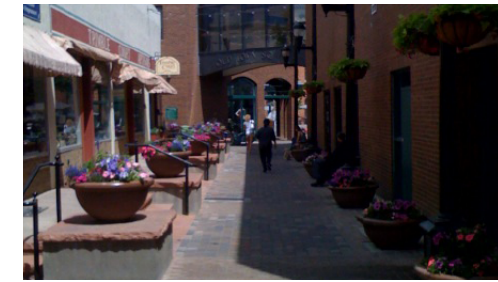

Pedestrian Walkway

Non motorized path. May range from unpaved urban trail to an urban and central street.



Public Transit

Red tape to indicate the addition of transit to existing streets.



Bike Lane

Green tape to indicate the addition of bike lanes to existing streets.

